



Current rating

A	B	C	D	E	F	G
3A	4A	5A	6A	10A	12A	15A

Input power	12VDC / 32VDC / 50VDC / 125VAC / 250VAC
Dielectric strength	1500VAC / 1 minute
Interrupt capacity	125VAC x 1000A, 250VAC x 1000A 250VAC x 200A(P6700), 125VAC x 100A(P6702)
Calibration	25°C-100% of rated current-continuously carried 25°C-between 101% and 145%-may trip or not 25°C-150% of rated current-trip within 1 hour 25°C-200% of rated current-trip within 1 minute
Contact endurance	125VAC x 200% of rated current 500 cycles
Reset	manual push reset / auto reset

P6690
Illuminated circuit breaker
Rating: 2 - 20Amp
UL : 2-20A 125V/250V
TUV: 3-16A 250V
VDE: 3-16A 250V

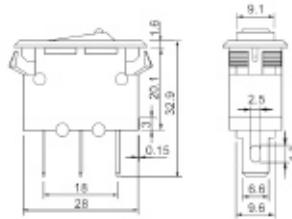

Overload	2 - 20 A
600%	0.1 - 1.8 sec
500%	0.2 - 2.8 sec
400%	0.35 - 5.0 sec
300%	0.7 - 10 sec
200%	3.5 - 60 sec
150%	trip within 1 hr
100%	no trip

P6700
Circuit breaker
Rating: 2 - 16Amp
CSA: 3-15A 125V
VDE: 4-10A 250V
11-16A 125V

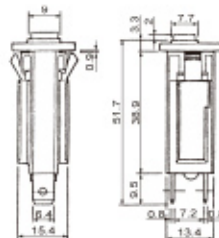

Overload	2 - 16 A
600%	0.3 - 3.0 sec
500%	0.4 - 5.5 sec
400%	0.5 - 9.5 sec
300%	0.8 - 12 sec
200%	4.0 - 30 sec
135%	trip within 1 hr
105%	no trip

P6702
Circuit breaker
Rating: 4 - 9Amp 12V/125V

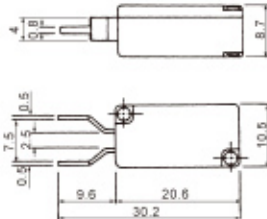

Overload	1.5 - 10 A
400%	0.45 - 5.0 sec
300%	0.8 - 10 sec
200%	4.0 - 60 sec
175%	trip within 1 hr
100%	no trip

P6704
Circuit breaker
Rating: 1 - 20Amp 12V/125V
CSA: 2 - 15A 125V
VDE: 2 - 16A 250V

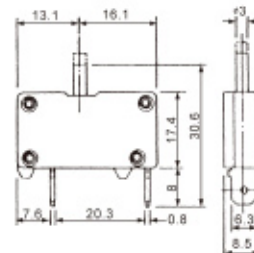

Overload	1 - 20 A
500%	0.2 - 2.0 sec
400%	0.4 - 5.0 sec
300%	0.8 - 15 sec
200%	4.0 - 60 sec
175%	trip within 1 hr
100%	no trip

P6706
Circuit breaker
Rating: 3 - 16Amp
UL : 4 - 15A 125V
CSA: 3 - 15A 125V

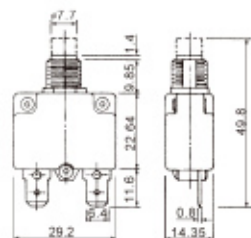

Overload	3 - 16 A
600%	0.3 - 3.0 sec
500%	0.4 - 5.5 sec
400%	0.5 - 9.5 sec
300%	0.8 - 12 sec
200%	4.0 - 30 sec
135%	trip within 1 hr
105%	no trip

P6708
Circuit breaker
Rating: 3 - 40Amp
UL : 3 - 30A 125V/250V
CSA: 3 - 30A 125V
5 - 30A 250V
VDE: 4 - 30A 250V

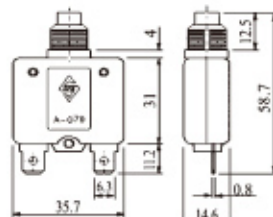

Overload	3A & 4A	Overload	5A ~ 40A
600%	0.6 - 2.0 sec	600%	0.6 - 1.7 sec
500%	1.0 - 5.0 sec	500%	0.8 - 2.5 sec
400%	1.2 - 8.0 sec	400%	1.6 - 7.0 sec
300%	2.5 - 11 sec	300%	2.5 - 11 sec
200%	4.0 - 40 sec	200%	4.0 - 30 sec
185%	trip within 1 hr	150%	trip within 1 hr
100%	no trip	100%	no trip
35A-40A trip within 1 min. at 200%			

P6720 x (from P6720 to P6724)



Temperature :

Code	A	B	C	D	E	F	G	H	J	K	L	M
°C	75	80	85	90	95	100	105	110	120	130	140	150

Item	P67210	P67212	Others
Operating tolerance	±5°C		±5°C, ±8°C, ±10°C
Reset differential	10°C~50°C		10°C~50°C
Input power	12V/24V/125V/250V		32V/125V/250V
Reset type	auto reset		auto reset
Interrupt capacity	125Vx20A-5cycles	125Vx30A-5cycles	125Vx60A-5cycles
Overshoot Temp.	180°C/3 min.	200°C/3 min.	200°C/5 min.
Dielectric strength	1500VAC/1min.		1500VAC/1min.

P6720
Thermostat (NC)
UL: 10A 125V
UL: 6A 250V



75°C -145°C at no load

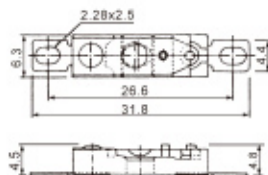

Contacts endurance:(resistive load)
32VDC x 100mA-50000 cycles
125VDC x 5A-50000 cycles
125VAC x 10A-30000 cycles
250VAC x 4A-30000 cycles

Applications:
.Hair dryer
.Heat sink
.Print circuit board
.Common protection

P67201
Thermostat (NC)
UL: 10A 125V
UL: 6A 250V



75°C -145°C at no load

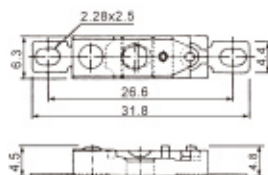

Contacts endurance:(resistive load)
32VDC x 100mA-50000 cycles
125VDC x 5A-50000 cycles
125VAC x 10A-30000 cycles
250VAC x 4A-30000 cycles

Applications:
.Hair dryer
.Heat sink
.Print circuit board
.Common protection

P67210
Thermostat (NC)
4A 125V



50°C -135°C at no load

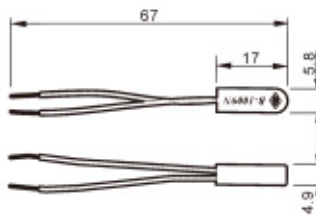

Contacts endurance:(resistive load)
24VDC x 100mA-50000 cycles
24VDC x 4A-10000 cycles
125VAC x 4A-10000 cycles
250VAC x 2A-10000 cycles

Applications:
.Motor winding
.Compact motor
.Transformer
.Heat fan
.Lighting ballast
.Common protection

P67212
Thermostat (NC)
UL: 6A 125V



45°C -120°C at no load

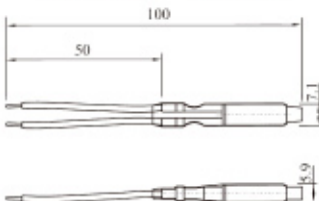

Contacts endurance:(resistive load)
24VDC x 100mA-50000 cycles
24VDC x 6A-10000 cycles
125VAC x 6A-10000 cycles
250VAC x 4A-10000 cycles

Applications:
.Motor winding
.Compact motor
.Transformer
.Heat fan
.Lighting ballast
.Common protection

P6722
Thermostat (NC)
UL : 10A 125V
CSA: 10A 125V



75°C -145°C at no load

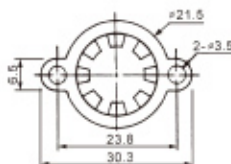

Contacts endurance:(resistive load)
32VDC x 100mA- 50000 cycles
125VDC x 10A-100000 cycles
125VAC x 15A- 30000 cycles
250VAC x 6A- 30000 cycles

Applications:
.Temperature controller
.Coffee maker
.Dish washer
.Hot plate
.Home appliance
.Common protection

P6724
Thermostat (NC)
UL : 10A 125V
CSA: 10A 125V



75°C -145°C at no load

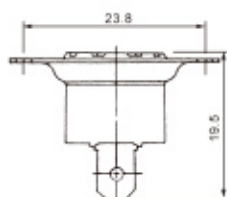

Contacts endurance:(resistive load)
32VDC x 100mA- 50000 cycles
125VDC x 10A-100000 cycles
125VAC x 15A- 30000 cycles
250VAC x 6A- 30000 cycles

Applications:
.Temperature controller
.Coffee maker
.Dish washer
.Hot plate
.Home appliance
.Common protection